

THE STAR EVENT CENTRE FLOOR PLAN AND CAPACITY GUIDE

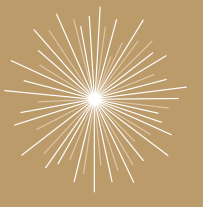

LEVEL 3 FLOOR PLAN

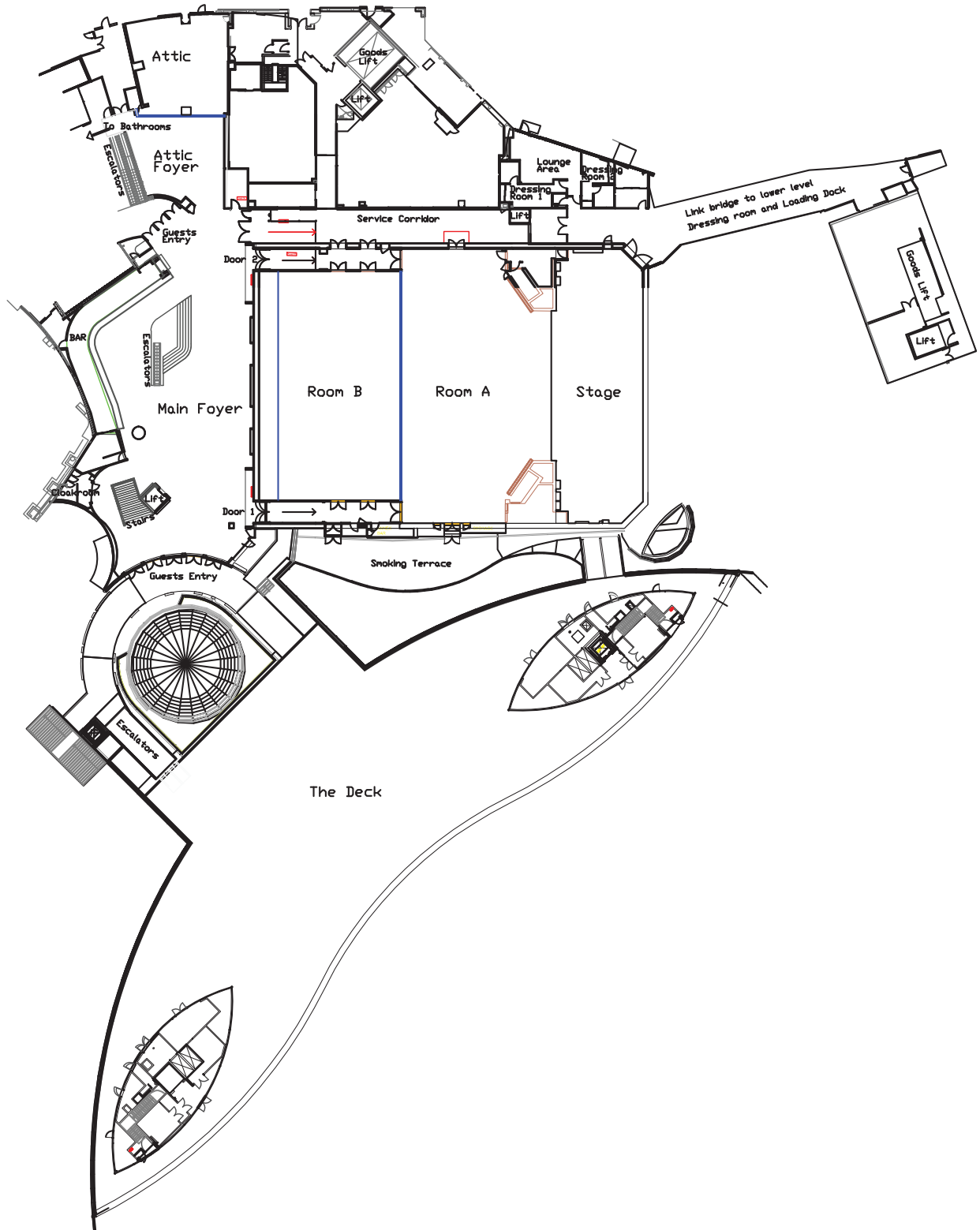

THE | STAR
SYDNEY

80 PYRMONT ST, PYRMONT NSW 2009 | 1800 700 700 | STAR.COM.AU

LONGITUDINAL FLOOR PLAN

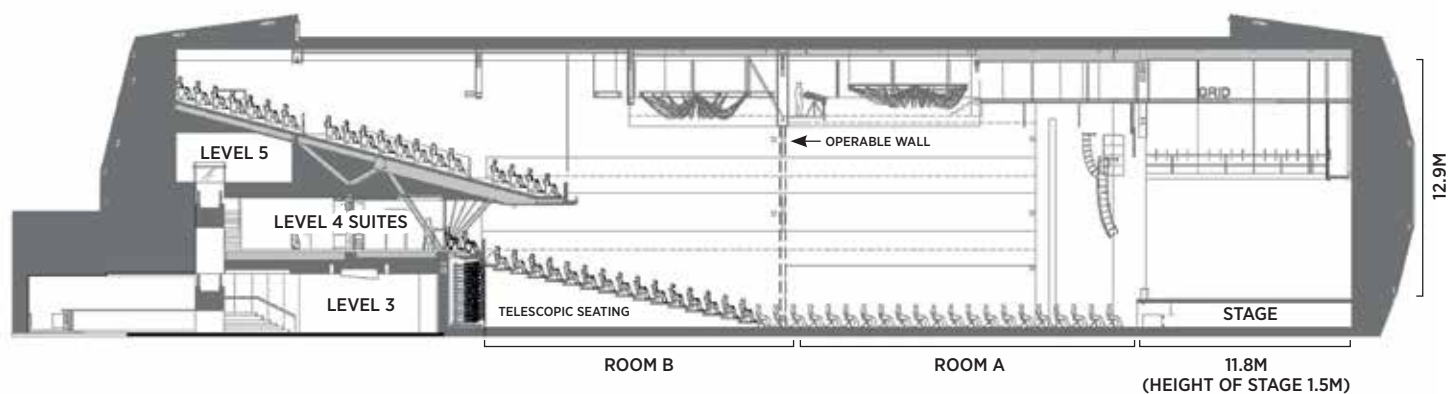

THE STAR EVENT CENTRE CAPACITIES								
VENUE	THEATRE	THEATRE	BANQUET	BANQUET	CABARET	CABARET	CLASSROOM	COCKTAIL
	Flat floor only - 1077sqm	Flat floor and retractable seating	5.5ft Rounds	6ft Rounds	5.5ft Rounds 8 pax/ table	6ft Rounds 8 pax/ table	3 pax/ table	
EXCLUSIVE Main Room	1474	1530 810 Flat floor plus 720 retractable	960 No dance floor	830 No dance floor	768	664	657	2000 - 2200
			830 With dance floor	750 With dance floor				
ROOM A 589sqm	805		470 No dance floor	430 No dance floor	376	344	297	800 - 1000
			420 With dance floor	380 With dance floor				
ROOM B 467sqm	504		300 No dance floor	270 No dance floor	290	216	201	500 - 800
			240 With dance floor	210 With dance floor				
ATTIC 143sqm	99 With stage		90 No dance floor	80 No dance floor	48	48	60	100
	110 Without stage		60 With dance floor	60 With dance floor				
FOYER								800
THE DECK (Sky Terrace)								950
BALCONY	981							
SUITE A	19							
SUITE B	28							
SUITE C	28							
SUITE D	19							
GALLERY A	39							
GALLERY B	34							
GALLERY C	32							
GALLERY D	32							

DRESSING ROOMS			
Star Dressing Room, Level 3		Dressing Rooms and Production Offices, Level 1	
Dressing Room 1: 6 pax	Dressing Room 3: 10-15 pax	Dressing Room 6: 4 pax	Production office 1: 2-4 pax
Dressing Room 2: 2 pax	Dressing Room 4: 12 pax	Dressing Room 7: 2 pax	Production office 2: 2-4 pax
Lounge and Dining Room area: 10-15 pax	Dressing Room 5: 6 pax	Dressing Room 8: 1 pax	

NOTES:

1. Cabaret capacities may increase or decrease based on having 6, 7 or 8 guests per table (above is based on 8 per table).
2. All final floor plans must be approved by The Star.
3. Maximum capacities are subject to review based on final event set-up and AV requirements.