



GENERAL FACTSHEET



CROWN TOWERS SYDNEY

## CROWN TOWERS SYDNEY

The hotel has been designed not just to frame the views of Sydney Harbour's icons, but to stand alongside them as a defining landmark of this beautiful city. The sculptural form of the building is reminiscent of three petals twisting together towards the sky, designed by award-winning British architecture firm Wilkinson Eyre.

Prestigious New York City-based Meyer Davis created thoughtful touches effortlessly integrating Crown's signature luxury with Sydney's coastal landscape. Bespoke design features in natural and aqua hues compose a modern residential décor with generous spaces, intuitive technology and perfectly framed waterfront or city skyline views.





GUEST ROOMS AND SUITES

At 275m high, Crown Towers Sydney rises majestically above the bustling Barangaroo precinct. The hotel comprises 349 total guest rooms, including various high-rise villas and two premium villas, providing guests with the choice of stunning waterfront or city skyline views.

TOTAL AVAILABLE	ROOM TYPE
69	Deluxe King
45	Harbour Bridge King
8	Harbour Bridge Twin
65	Opera King
26	Opera Twin
17	Studio Room
4	Harbour Bridge Studio
13	Opera Studio
8	Executive Suite
21	Executive Harbour Bridge Suite
13	Executive Opera Suite
17	Premier Harbour Bridge Suite
4	Tower Suite
13	Opera Tower Suite
2	Crystal Harbour Bridge Suite 2 Bedroom
3	Crystal Harbour Bridge Suite 3 Bedroom
1	Crystal Opera Suite
4	One Bedroom Deluxe Villa
4	One Bedroom Crystal Villa
12	Two Bedroom Crystal Villa
1	Tower Villa
1	Crown Presidential Villa





## CROWN TOWERS SYDNEY

### LOCATION

Barangaroo is fast becoming Sydney's most exciting commercial and cultural hub with sprawling parklands, public art and a plethora of restaurants and bars. It is also connected to Circular Quay by the city's newest ferry terminal and a short fifteen-minute drive to the local and international airports.



### CROWN SPA AND FITNESS STUDIO

Blainey North's brief was precise, to design the world's best day spa. Drawing inspiration from the subconscious, the space allows guests to completely immerse themselves in their wellness experience. Insulated from the rest of the hotel, Crown Spa offers indulgent treatments as well as a private fitness studio and open-air tennis court. The expansive pool and terrace has been designed with horizon overflows connecting directly to the panoramic views. As well as secluded cabanas and plush day beds to create an extraordinary resort oasis.

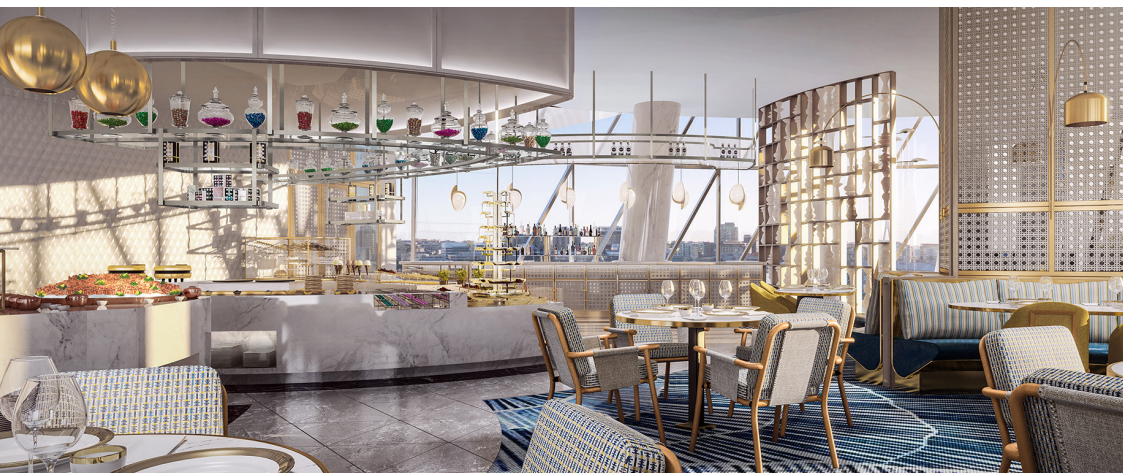

### CROWN DINING AND RETAIL

Crown's bars and restaurants are helmed by some of the world's greatest chefs. Guests can enjoy an abundance of culinary experiences while soaking up the magnificent harbour views of Australia's most iconic harbour. From fine dining to casual bites, Crown has establishments designed to suit every occasion.

The luxury shopping arcade is home to some of the world's greatest designers, including some of the finest jewellery and watches in Australia. Guests are invited to explore the elegant boutiques, hosting unparalleled service for a world-class shopping experience.





CROWN EVENTS AND CONFERENCES

With flawless service and exclusivity, Crown’s meeting and event spaces set a new benchmark in Sydney.

ROOM TYPE	SIZE	NO. OF GUESTS
Pearl Ballroom	596 sqm	Banquet: 400 guests
		Banquet with stage: 350 guests
		Wedding: 350 guests
		Classroom: 200 guests
		Theatre: 450 guests
Opal Suite	178 sqm	20 – 40 guests
Pre-Function Area	472 sqm	

